

Flowfast Terroso



An eye-catching, wear resistant and fast cure MMA flooring system with a decorative flake finish.



Fast Cure:

Accelerates cure time, providing a fully operational surface in just 60 minutes



Decorative:

Available in vibrant flake color mixes that can be matched to neighboring interiors



Wear Resistant:

Excellent wear resistant surface for wheeled traffic



Hygiene:

Easy to clean and maintain

Technical Information¹

REACTION TO FIRE

C _{fl} -s1	EN 13501-1
---------------------	------------

SLIP RESISTANCE²

Dry > 40	EN 13036-4
----------	------------

TEMPERATURE RESISTANCE

-35°C to +50°C

WATER PERMEABILITY

Karsten test - Nil (Impermeable)

WEAR RESISTANCE

RWA1	PN-EN 13892-5
------	---------------

IMPACT RESISTANCE

≥ IR10	PN-EN ISO 6272-1
--------	------------------

BOND STRENGTH

Greater than cohesive strength of 25 N/mm² concrete (> 1,5 MPa)

SPEED OF CURE

Full cure after 120 minutes

System Design

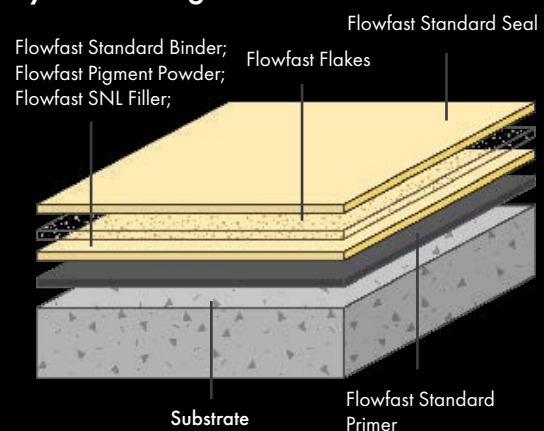

Standard colour chart



Dali



Van Gogh



Picasso



Klimt



Renoir



Matisse



Da Vinci



Rembrandt

The applied colours may differ from the examples shown.
For a full colour chart and samples, contact your local CPG Europe office.

¹ The figures in the table beside are typical properties achieved in laboratory tests – these results may vary depending on the conditions on the installation site. ² The final anti-slip properties of the floor are influenced by the application method, the size and shape of the aggregate used for the topcoat (aggregate recommendations available from CPG Eastern Europe), the degree of abrasion, maintenance and the nature the dirt.

Model Specification

System:	Flowfast Terrosso
Finish:	Satin
Thickness:	approx. 2,5 mm
Colour	According to the catalog
Producer:	CPG Europe
Supplier:	Tremco CPG Poland Sp. z o.o.
Telephone:	+48 22 879 89 07

Installation Service

The installation should be carried out by a Flowcrete approved contractors with a documented quality assurance scheme. Obtain details of our approved contractors by contacting CPG Eastern Europe or enquiring via our website at www.flowcrete.com.pl.

Products Included in this System

Primer²:	Flowfast Standard Primer
Bodycoat + Flakes:	Flowfast Standard Binder Flowfast Pigment Powder Flowfast SNL Filler Flowfast Flakes
Sealer:	Flowfast Standard Seal

² If other resins are used contact CPG Eastern Europe for further details.

Detailed application instructions are available upon request.

Substrate Requirements

Concrete or screed substrate should be class min. C20/25, a minimum bond strength of 1,5 MPa (pull-off test), surface even, clean, free from laitance, dust and other contamination. All damages in the substrate should be repaired prior to applying the flooring. The substrate should be dry to 95% RH as per BS 8204 and free from rising damp and ground water pressure. In case of higher humidity, one should use Hydraseal DPM/ Flowfast Damp Primer as primer. Details to be found in the *Flowcrete Resin Flooring Substrate Requirements*.

Aftercare – Cleaning and Maintenance

Clean regularly manually or using a machine in conjunction with a mildly alkaline detergent. Flowcrete Flooring Cleaning Instruction available upon request.

Environmental Considerations

The finished system is assessed as non-hazardous to health and the environment. The long service life and seamless, impermeable surface with perfect adhesion to the substrate reduce the need for repairs and maintenance.

Technical information, recommendations and instructions concerning the product use, storage and maintenance included in this System Data Sheet are based on Tremco CPG Poland Sp. z o.o. (further related as „CPG Polska”) knowledge and experience, reflecting the best acknowledged way of using the material for a given moment. Taking into consideration other factors that are beyond the producer’s control, including differences in quality of substrates, tools and other complementary materials, weather conditions, proper installation and also cleaning and maintenance, CPG Polska cannot take responsibility in case of failure to conform with information and instructions included in this System Data Sheet or, respectively, written recommendations from authorized CPG Polska representatives. One should always conform with up-to-date norms and building principles, and also safety, hygiene and health protection rules according to the information included in Material Safety Data Sheets and also on the products packaging. This System Data Sheet replaces all previous versions. In order to receive up-to-date System Data Sheets contact CPG Polska.

25/05/21

CPG Eastern Europe
ul. Marywilska 34, 03-228 Warsaw, Poland
tel.: +48 22 879 8907
email: poland@cpg-europe.com

 **Construction
Products Group**
Europe

www.flowcrete.com.pl